

Anets SilverLine 14" Gas Fryer

Model SLG40

Item No.

Built To Anets Standards, Priced For Today's Market, The SilverLine Fryer From Anets

Anets provides the best value in frying with the new SLG40 gas fryer. The improved design provides an affordable fryer that keeps up with load after load of production. The heating system has been engineered for maximum efficiency and cleanability. Using 2 burner tubes equipped with computer designed radiants, this fryer requires only 90,000 BTU input to achieve maximum cooking capacity. The unique shape of the tubes allows easy access to all areas of the frypot. Center mounted snap action thermostat responds quickly to fry loads. The Anets SLG40 is built to perform, easy to clean, and priced to purchase today.

STANDARD FEATURES

- Stainless steel front, door and trim are standard features
- 90,000 BTUH from only two tubes, easiest model on the market to clean
- Computer designed radiants enable the burners to efficiently reach 45,000 BTUH per burner tube
- The unique tapered elliptical tubes provide 14% more heat transfer area than competitive models (see Design Features on back)
- Outstanding serviceability, all components easily accessible and replaceable from the front
- Stainless steel basket hanger lifts off for easy cleaning
- Food particles fall below burner tubes into cold zone to prolong shortening life
- Large 1 1/4" ball-type full port drain valve prevents clogging

DOSZE
EQUIPMENT
WWW.DOSZE.COM.CO



ANETS
SilverLINE™

DOSZE
EQUIPMENT
WWW.DOSZE.COM.CO



ANETS'
L10-507 Rev 1 (09/10)

Anetsberger, LLC
P.O. Box 501 • Concord, New Hampshire, 03301 • U.S.A
1-603-225-6684 • Fax 1-603-225-8497 • www.anetsberger.com

Anets SilverLine 14" Gas Fryer

Model SLG40

SPECIFICATIONS

- Model SLG40, Stainless steel frypot
- Certification NSF, ETL, CETL
- Gas Input 90,000, BTU/hr.
- Gas Pressure NG 3.5" WC, LP 10" WC
- Gas Connection 1/2" NPT
- Electrical Requirements None
- Thermostat Snap action millivolt control
- Temperature Range 200°-400°F, (93°-204°C)
- Hi-Limit Safety control turns off gas supply at 440°F (227°C)
- Safety Pilot 100% gas shut off valve
- Burners Cast iron, atmospheric pre-mix
- Frypot Stainless steel
- Cabinet Door, stainless steel
- Shortening Capacity Backsplash, stainless steel
- Frying Area Basket Hanger, stainless steel
- Shipping Weight 40 lbs
- Warranty 1 year parts and labor
- Stainless steel frypot: 5 years (pro-rated)

STANDARD ACCESSORIES

- 2 Twin nickel plated baskets
- Rack type basket support
- 6" Adjustable legs
- Drain pipe extension
- Flue extension/Diverter

OPTIONS AND ACCESSORIES

- Single or triple baskets
- Casters

DESIGN FEATURES

Two Tubes

- Easier to clean
- Optimum access to cold zone

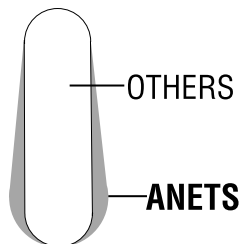
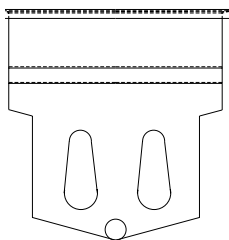

Tapered Elliptical Shape

- 14% more surface area for heat transfer
- Food particles cannot accumulate on top of tubes

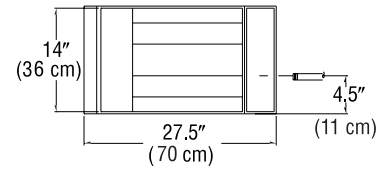

Top View

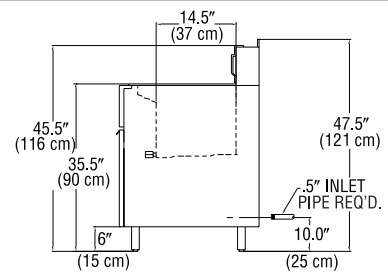

Side View

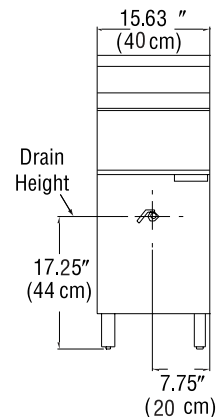

Front View

Specifications subject to change without notice.

Printed in the U.S.A.

DOSZE
EQUIPMENT
WWW.DOSZE.COM.CO

ANETS'
L10-507 Rev 1 (09/10)

Anetsberge, LLC
P.O. Box 501 Concord, New Hampshire, 03301 U.S.A
1-603-225-6684 Fax 1-603-225-8497 www.anetsberger.com